

**RUBIDOUX COMMUNITY SERVICES DISTRICT
CONTRACT DOCUMENTS AND SPECIFICATIONS
FOR
MARKET STREET AND 24TH STREET PIPELINE RELOCATION**

ADDENDUM NO. 2

PLEASE BE ADVISED:

The following clarifications, changes, additions, and/or corrections hereinafter set forth shall be incorporated into the project Contract Documents, and shall be made a part thereof, subject to all the requirements thereof, as if originally specified and/or shown.

- 1. Reference:** Construction Drawings

Replace the Construction Drawings in their entirety with the Drawings attached hereto.

- 2. Reference:** Construction Specifications, Special Requirements, Section 30, Pipeline Connections and Disinfection:

Add the following to the end of Section 30, Pipeline Connections and Disinfection:

Both connections to the existing pipeline will be accomplished at night, during low water demand. Both connections will be accomplished during the same 8-hour work period. Contractor shall notify the District two (2) weeks in advance of the planned connection work and also provide 48 hour and 24 hour advance confirmation of when the work will be performed.

The Contractor shall be responsible for dewatering, dechlorination, and disposal of all water from the pipeline connection work, in addition to testing/flushing activities. Discharge of all water must abide by the District's NPDES permit which limits the total residual chlorine to a maximum concentration of 0.1 mg/l.

Contractor should not expect valves to shut completely (100%). Contractor shall also protect existing water pipelines during connection procedures.

Contractor must coordinate with the District to dewater the existing water system and complete all specified connections to existing water pipelines within the allowable shut-down period. To facilitate completing all connection work and minimize shut-down time, Contractor shall excavate connection points and install trench plates in advance of any connection work. Contractor shall have all pipe materials and fittings ready, on-site, and assembled prior to starting connection work. In addition, pipeline must have passed all required testing prior to any tie-in work. Contractor shall provide all necessary notifications to RCSD inspector and City of Jurupa Valley inspector for all night time work.

All costs associated with connection work shall be included in respective bid items for connection work (Bid Items 107 and 108) and no additional compensation shall be allowed.



By: _____
Sinisa Saric, RCE No. 65367

Date: April 5, 2023

Bidder hereby acknowledges receipt of Addendum No. 2 and the incorporation thereof in Bid Proposal for the Market Street and 24th Street Pipeline Relocation.

Bidder: _____

By: _____
(Bidder's Authorized Representative)

Date: _____

Title: _____

587/19P62-ADD-2.doc

Attachments: Construction Drawings, Sheets 1 through 3

RUBIDOUX COMMUNITY SERVICES DISTRICT

MARKET STREET AND 24TH STREET PIPELINE RELOCATION

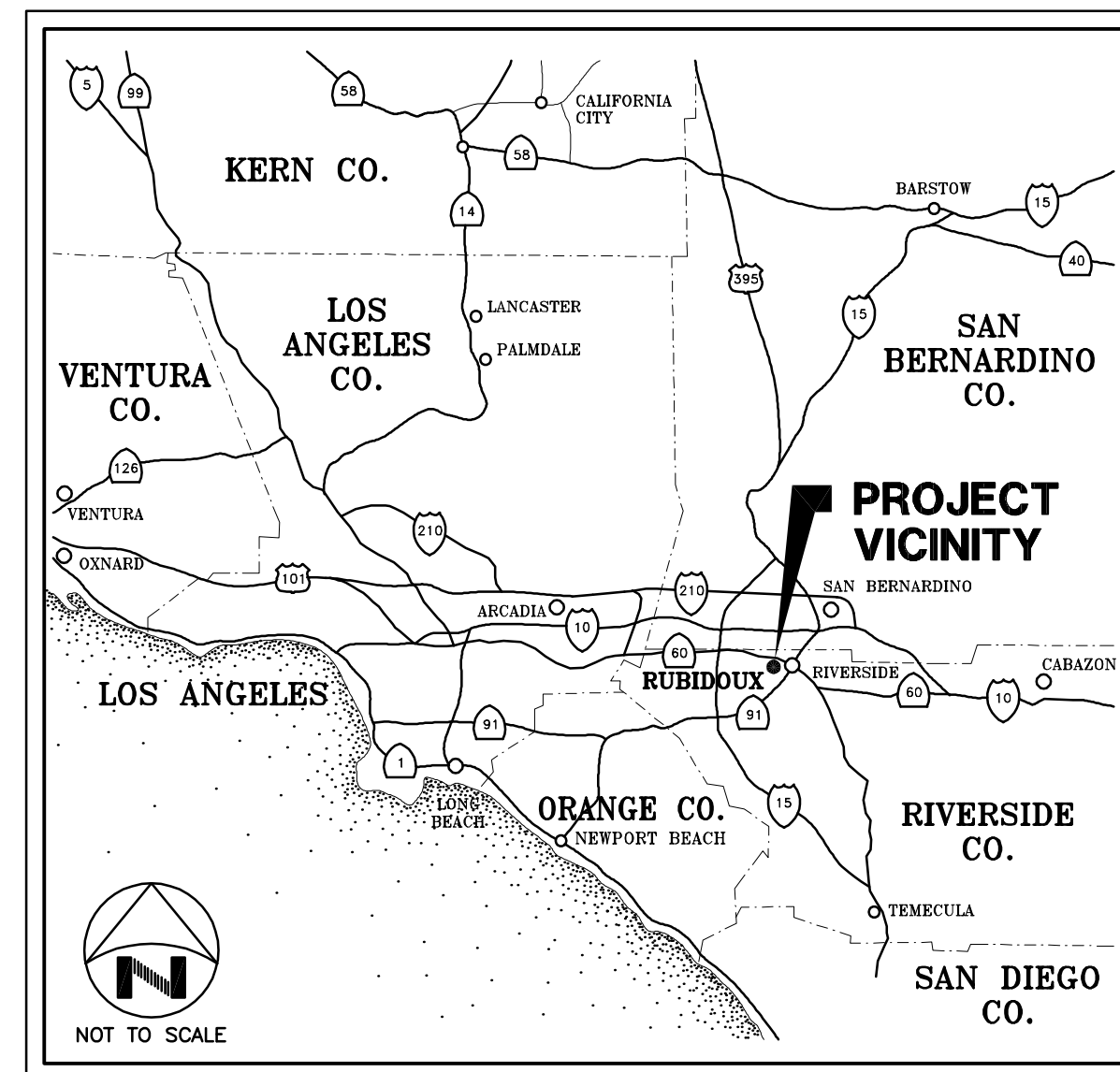

VICINITY MAP

DRAWING INDEX

SHEET No.	DESCRIPTION
1	TITLE SHEET, LOCATION AND VICINITY MAPS, DRAWING INDEX, AND LEGEND
2	CONSTRUCTION NOTES
3	PLAN AND PROFILE - STA.10+05.0± TO STA.12+06.0±

LEGEND

SYMBOL	DESCRIPTION
	EXISTING EDGE OF PAVEMENT
	EXISTING WATERLINE
	EXISTING ELECTRICAL FACILITY
	EXISTING OVERHEAD ELECTRICAL FACILITY
	EXISTING GAS FACILITY
	EXISTING SEWER FACILITY
	EXISTING SEWER FORCE MAIN FACILITY
	EXISTING STORM DRAIN FACILITY
	EXISTING TELEPHONE FACILITY
	EXISTING FIBER OPTIC FACILITY
	EXISTING TELEPHONE MANHOLE
	EXISTING POWER POLE
	EXISTING RIGHT-OF-WAY
	PROPOSED PIPELINE
	UTILITY INTERFERENCE FLAG. APPROXIMATE LOCATION OF INTERFERENCE WITH TYPE OF UTILITY INDICATED BY ABBREVIATION: CATV- CABLE TV, E- ELECTRIC, G- GAS, S- SEWER, SD- STORM DRAIN, T- TELEPHONE, TR- TRAFFIC, AND W- WATER.
	DIP

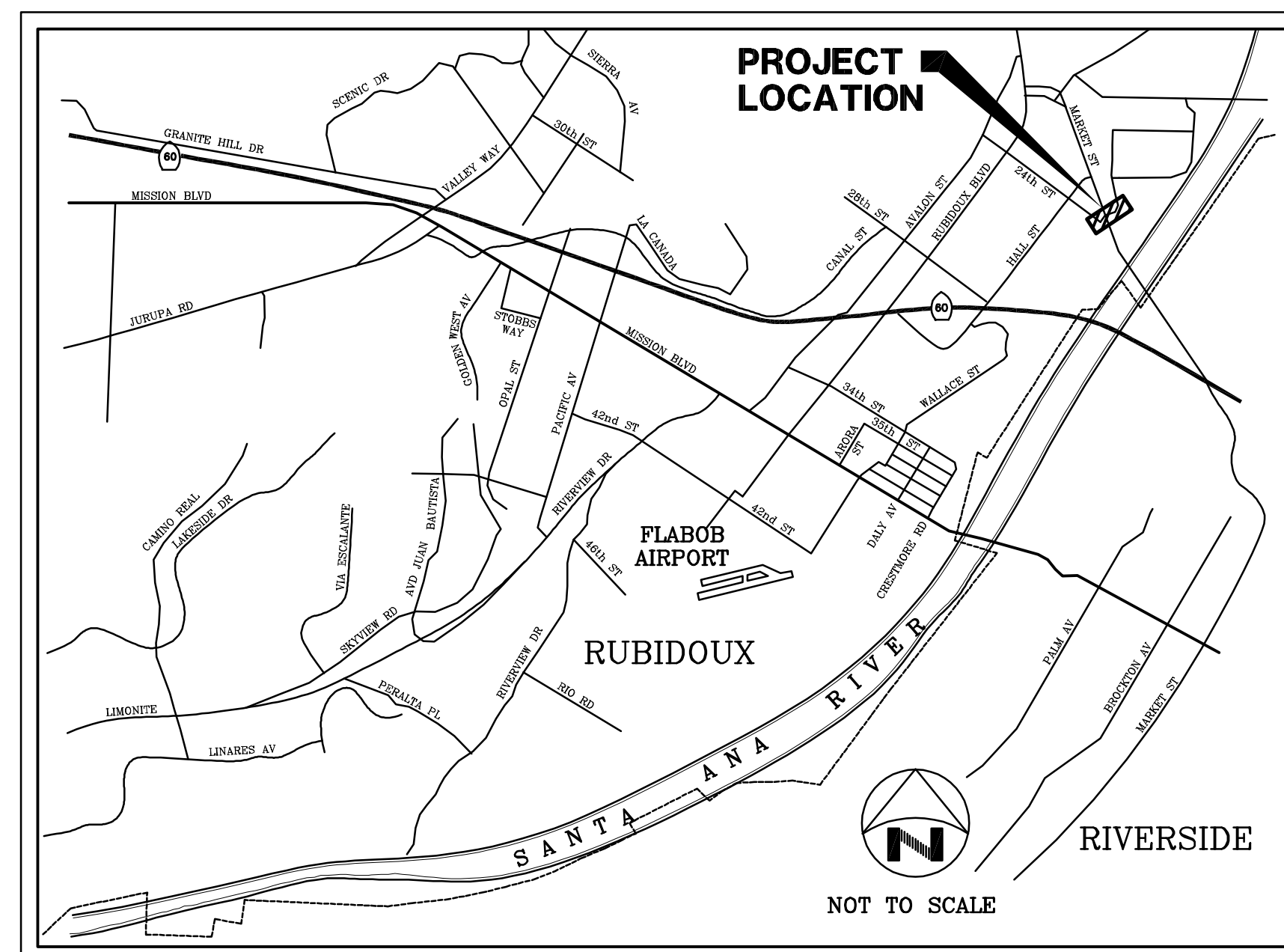

LOCATION MAP

DWG. NO.: 587-19.62_31 FILE NO.: 587-19.62_UPDATE BY: TMM PROJ. ENG.: SS PLOT DATE: 03/17/23 PLOT TIME: 6:31AM PLOT SCALE: 1"=1'

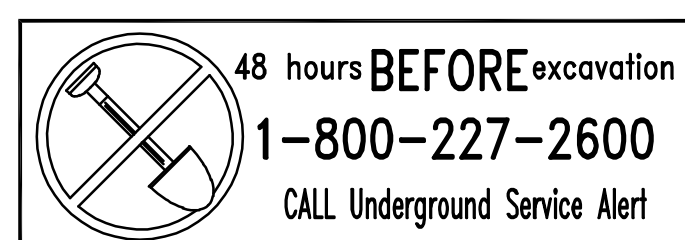

VERIFY SCALES
BAR IS ONE INCH ON ORIGINAL DRAWING

IF NOT ONE INCH ON THIS SHEET, ADJUST SCALES ACCORDINGLY

RUBIDOUX COMMUNITY SERVICES DISTRICT
APPROVED BY: TED BECKWITH, RCE No. 48798
DIRECTOR OF ENGINEERING
DATE: _____

SYM	REVISIONS	DATE	BY



KRS KRIEGER & STEWART
Engineering Consultants
3602 University Avenue • Riverside, CA 92501
www.kriegerandstewart.com • 951-684-6900
APPROVED BY: [Signature]
REGISTERED ENGINEER No. 65367 DATE 03/16/23

SCALE	AS SHOWN
FIELD BOOK	N/A
DESIGN	SS
DRAWN	SPK
CHECKED	SS

RUBIDOUX COMMUNITY SERVICES DISTRICT
MARKET STREET AND 24TH STREET
PIPELINE RELOCATION
**TITLE SHEET, LOCATION AND VICINITY
MAPS, DRAWING INDEX, AND LEGEND**

SHEET
1
OF 3 SHEETS
R.C.S.D. PLAN No. 587-19.62

